

# Licensing Act Sub-Committee

## Agenda

---

**Date:** Wednesday, 2nd August, 2017  
**Time:** 10.00 am  
**Venue:** East Committee Room - Municipal Buildings, Earle Street, Crewe, CW1 2BJ

---

The agenda is divided into 2 parts. Part 1 is taken in the presence of the public and press. Part 2 items will be considered in the absence of the public and press for the reasons indicated on the agenda and at the foot of each report.

It should be noted that Part 1 items of Cheshire East Council decision making and Overview and Scrutiny meetings are audio recorded and the recordings will be uploaded to the Council's website.

### **PART 1 – MATTERS TO BE CONSIDERED WITH THE PUBLIC AND PRESS PRESENT**

1. **Appointment of Chairman**

To appoint a Chairman for the meeting.

2. **Declarations of Interest**

To provide an opportunity for Members and Officers to declare any disclosable pecuniary and non-pecuniary interests in any item on the agenda and for Members to declare if they have pre-determined any item on the agenda.

3. **Application for a Premises Licence - Craft Ale Bar, Castle Street, Nantwich CW5 5BA** (Pages 7 - 46)

To consider an application for a Premises Licence by Peter Terry in respect of Craft Ale Bar, Castle Street, Nantwich, Cheshire CW5 5BA.

### **THERE ARE NO PART 2 ITEMS**

---

For requests for further information

**Contact:** Julie Zientek  
**Tel:** 01270 686466  
**E-Mail:** [julie.zientek@cheshireeast.gov.uk](mailto:julie.zientek@cheshireeast.gov.uk)

**This page is intentionally left blank**

## CHESHIRE EAST COUNCIL

**Procedure for Hearings – Licensing Act 2003****The Licensing Committee**

The full Licensing Committee consists of fifteen elected Members of the Council. From this full Committee will be drawn sub-committees of three members to deal with licensing functions under the Licensing Act 2003. The Chairman and Vice Chairman of the Licensing Committee shall have the discretion to refer a matter up to a hearing of the full Licensing Committee.

**Officers at Hearings**

- **The Committee Officer** introduces all parties and records the proceedings
- **The Legal Adviser** provides independent advice to the Members on legal matters and procedure.
- **The Licensing Officer** will introduce the matter and outline the application; the officer will also answer any questions Members may have.

**PROCEDURE**

NOTE: If the Sub-Committee has not already elected a Chairman, that will be the first item of business.

<b>1</b>	<b>Chairman</b>	The Chairman will: (i) call the matter to be considered (ii) call for any declarations of interest (iii) ask all parties to introduce themselves (iv) summarise the procedure to be followed at the hearing (v) will consider any request made by a party for another person to appear at the hearing (v) will advise the parties of any maximum period of time in which it has to present its case (if a maximum is imposed this shall be equal for all parties)
<b>2</b>	<b>Licensing Officer</b>	Will introduce and summarise the application, highlighting areas of contention or dispute.
<b>3</b>	<b>Committee Members</b>	May ask questions of the Licensing Officer
<b>4</b>	<b>Applicant</b>	Will present his/her case, calling witnesses, as appropriate.  <i>(If necessary, applicant will produce any notices required by law. Legal Adviser will draw attention to this if required.)</i>

5	<b>Responsible Authorities</b>  (who have made representations)	Each in turn may ask <u>questions</u> of the applicant, by way of clarification.
6	<b>Other Persons</b>  (who have made representations)	To be invited to ask <u>questions</u> of the applicant, by way of clarification.  <i>It is normal practice for a spokesperson only to speak on behalf of a group of residents.</i>
7	<b>Committee Members</b>	Each in turn may ask <u>questions</u> of the applicant.
8	<b>Applicant</b>	May make a <u>statement</u> or ask his witnesses to clarify any matters which he feels are unclear, or may have been misunderstood.
9	<b>Responsible Authorities</b>	Will make their representations.
10	<b>Applicant</b>	Or his representative or witnesses to ask <u>questions</u> of Responsible Authorities represented at the meeting, by way of clarification.
11	<b>Other Persons</b>  (who have made representations)	May ask <u>questions</u> of the Responsible Authorities represented at the meeting, by way of clarification.  <b>(Note: This is not the point at which they should be stating their objections.)</b>
12	<b>Committee Members</b>	May ask <u>questions</u> of the Responsible Authorities represented at the meeting
13	<b>Other Persons</b>  (who have made representations)	Those who have objected to the application will be invited <b><u>to make observations on the application</u></b> and present the bases of their objections.
15	<b>Applicant</b>	Or his representative or witnesses may ask <u>questions</u> of the other persons, by way of clarification.
16	<b>Committee Members</b>	May ask <u>questions</u> of the other persons.
17	<b>Chairman</b>	To invite both <b>Responsible Authorities</b> and <b>Other Persons</b> to make their closing addresses.
18	<b>Applicant</b>	Or his representative will <u>briefly summarise the application</u> and comment on the observations and any suggested

		conditions.
19	<b>Committee</b>	<u>Will retire</u> to consider the application. The Committee may request the Legal Advisor to advise on legal issues.
20	<b>Committee</b>	<p>Will return to <u>give its decision</u>, with reasons, which will be announced by the Chairman and subsequently confirmed in writing to the applicant and to all the parties that made representations.</p> <p>In cases where a decision cannot be given at the end of the hearing, parties will be advised of the decision within five working days.</p>

### Notes

1. The hearing shall normally be held in public. There may be occasions on which the Committee find it necessary to exclude members of the press and public; any such decision will be taken on the basis that the public interest in doing so outweighs the public interest in the hearing, or that part of the hearing taking place in public.
2. The Chairman may require any person behaving in a disruptive manner to leave the hearing and may (a) refuse to permit that person to return, or (b) permit him/her to return only on such conditions as the authority may specify, but any such person may submit in writing any information which they would have been entitled to provide orally if they had not been required to leave.
3. Prior to the hearing each party shall have given notification and served documentation (eg statements of witnesses or reports of experts) as required. Late representations and evidence will only be considered with the agreement of all parties.
4. Anyone entitled to be heard may be represented by any person, whether or not that person is legally qualified.
5. Hearsay will be permitted but the Sub-Committee will be reminded to give it appropriate weight.
6. Due note shall be taken of the provisions of the Hearings Regulations 2005.
7. The Chair may, in the interests of expediency or convenience of the parties, vary the procedure from time to time, provided notice is given to the parties and the rules of natural justice are observed.

## Summary of Procedure

1. Chairman appointed (if this has not been done previously).
2. Chairman to call for declarations of interest and request that all parties introduce themselves.
3. Chairman summarises the procedure for the hearing
4. The Licensing Officer summarises the application
5. Applicant to present his/her case.
6. Applicant to be questioned by all parties (to clarify points only) following which, he/she can clarify any other matters which he/she feels may have been misunderstood when the application was presented.
7. Applicant to be questioned by the Committee.
8. Responsible Authorities to make their representations following which they can be questioned by all parties by way of clarification.
9. Other Persons will be invited to present the bases of their objections, following which they can be questioned by all parties by way of clarification.
10. The applicant will be invited to sum up his/her case
11. Committee/Sub-Committee withdraws to make its decision
12. Committee/Sub-Committee returns to announce its decision to all present.

## CHESHIRE EAST COUNCIL

## REPORT TO: LICENSING ACT SUB-COMMITTEE

---

Date of Meeting:	Wednesday 2 August 2017
Report of:	Jennifer Knight, Licensing Officer
Subject/Title:	Application for a new Premises Licence at Craft Ale Bar Castle Street, Nantwich, CW5 5BA

---

**1.0 Report Summary**

- 1.1 The report provides details of an application for a Premises Licence, and the proposed operating schedule together with details of relevant representations received in relation to the application.

**2.0 Recommendations**

- 2.1 The Licensing Act Sub-Committee is requested to determine the application for a Premises Licence by Peter Terry in respect of:

**Craft Ale Bar  
Castle Street, Nantwich, Cheshire, CW5 5BA**

- 2.2 Acting in the capacity of Licensing Authority, Members must seek to promote the Licensing Objectives, and where Members consider matters have engaged one or more of the objectives, they may exercise their discretion. The licensing objectives are:

- (a) The prevention of crime and disorder
- (b) Public safety
- (c) The prevention of public nuisance
- (d) The protection of children from harm

- 2.3 Members of the Licensing Sub-Committee are reminded that they may not exercise discretion in any case, merely because it considers it desirable to do so. Careful consideration should be given to application and relevant representations in light of the proposed operating schedules.

- 2.4 The Sub-Committee in respect of this application must have regard to the Guidance issued under Section 182 of the Licensing Act 2003 and the Council's Statement of Licensing Policy.

- 2.5 Finally, Members are also reminded that in determining the application in accordance with the Licensing Act 2003, Members must also have regard to:

- The rules of natural justice
- The provisions of the Human Rights Act 1998

**3.0 Reasons for Recommendations**

- 3.1 The Licensing Act Sub-Committee has the power to determine this application in accordance with the provisions of the Licensing Act 2003 and the Council's Constitution.

#### **4.0 Wards Affected**

- 4.1 Nantwich South and Stapeley

#### **5.0 Local Ward Members**

Councillor Peter Groves  
Councillor Andrew Martin

#### **6.0 Policy Implications**

- 6.1 The Licensing Authority has adopted a Statement of Licensing Policy in accordance with section 5 of the Licensing Act 2003.

- 6.2 Whilst having regard to the general principles within the Statement, Members may wish to consider the following:

- 6.2.1 The representations relate to the Prevention of Crime and Disorder and the Prevention of Public Nuisance Licensing Objectives. The Licensing Authority sets out at paragraphs 7 and 9 respectively, of its Statement of Licensing Policy how it will deal with representations under these objectives. At paragraph 9.1 the Statement of licensing policy confirm that a broad interpretation of what constitutes a public nuisance will be taken
- The Statement of Licensing Policy has a specific section relating to noise nuisance. This section is reproduced for the benefit of the sub-committee at appendix 3

- 6.3 Members should provide reason(s) for any decision taken and should set out the reasoning where they determine to depart in any way from the Policy or Guidance.

#### **7.0 Financial Implications**

- 7.1 Not applicable.

#### **8.0 Legal Implications**

- 8.1 In accordance with the provisions of section 18 of the Licensing Act 2003 the Licensing Authority must, having regard to the representations, take such steps (if any) as it considers appropriate for the promotion of the licensing objectives. Section 18(4) provides that the authority may:

- (a) Grant the licence subject to the relevant mandatory conditions and conditions consistent with the operating schedule



- (b) Modify the application to such extent as the Authority considers appropriate for the promotion of the Licensing Objectives
- (c) Exclude from the scope of the licence any of the Licensable Activities to which the application relates
- (d) Refuse to specify a person in the licence as the Premises Supervisor
- (e) Reject the application.

8.2 Members are reminded that should any conditions be added, they should be practical, enforceable and appropriate to promote the Licensing Objectives.

8.3 Members are also reminded of the statutory obligation placed on the Local Authority under section 17 of the Crime and Disorder Act 1998 to through all of its various functions, and Licensing is one of those functions to do all that it can to prevent Crime and disorder, Anti-social Behaviour, behaviour adversely affecting the environment and re-offending.

## **9.0 Risk Management**

9.1 Section 181 and Schedule 5 of the Licensing Act 2003 make provision for appeal to the Magistrates' Court of any decision made by the Licensing Authority.

## **10.0 Background and Options**

10.1 The application was initially received on the 13<sup>th</sup> June 2017. The application is for new premises licence under Section 17 of the Licensing Act 2003.

10.2 The operating schedule indicates that the relevant licensable activities applied for are:

- Live Music Indoors
- Recorded Music Indoors
- Sale and supply of alcohol for on and off the premises

10.3 The hours applied for are as follows:

Live Music Indoors  
Monday – Sunday 10.00 – 22.00

Recorded Music Indoors  
Monday – Sunday 10.00 – 22.00

Sale and supply of alcohol for on and off the premises  
Monday – Sunday 10.00 – 22.00

10.4 A copy of the application form is attached as Appendix 1.

10.5 Relevant Representations are attached as Appendix 2.

Responsible Authorities:

10.6 Environmental Protection have agreed conditions to be imposed on the licence with the applicant attached at Appendix 2

Other Persons:

10.7 The Council has received one objection to the application

**11.0 Access to Information**

The background papers relating to this report can be inspected by contacting the report writer:

Name: Miss Jennifer Knight

Designation: Senior Licensing Officer

Tel No: 01270 686337

Email: Jennifer.knight@cheshireeast.gov.uk

**APPENDICES**

Appendix 1 – Premises Licence Application Form & Plan

Appendix 2 – Objection and agreed conditions from Environmental Health

Appendix 3 – Relevant parts of Licensing Policy

Appendix 4 – Site plan of premises



**Cheshire East**  
**Application for a premises licence**  
**Licensing Act 2003**

For help contact  
[licensing@cheshireeast.gov.uk](mailto:licensing@cheshireeast.gov.uk)  
 Telephone: 0300 123 5015

\* required information

## Section 1 of 21

You can save the form at any time and resume it later. You do not need to be logged in when you resume.

System reference

Not Currently In Use

This is the unique reference for this application generated by the system.

Your reference

You can put what you want here to help you track applications if you make lots of them. It is passed to the authority.

Are you an agent acting on behalf of the applicant?

☐ Yes ☒ No

Put "no" if you are applying on your own behalf or on behalf of a business you own or work for.

### Applicant Details

\* First name

Peter

\* Family name

Terry

\* E-mail

Main telephone number

Include country code.

Other telephone number

☒ Indicate here if you would prefer not to be contacted by telephone

Are you:

- ☐ Applying as a business or organisation, including as a sole trader
- ☒ Applying as an individual

A sole trader is a business owned by one person without any special legal structure. Applying as an individual means you are applying so you can be employed, or for some other personal reason, such as following a hobby.

*Continued from previous page...*

**Your Address**

Address official correspondence should be sent to.

* Building number or name	<input type="text"/>
* Street	<input type="text"/>
District	<input type="text"/>
* City or town	<input type="text"/>
County or administrative area	<input type="text"/>
* Postcode	<input type="text"/>
* Country	<input type="text"/>

**Section 2 of 21**

**PREMISES DETAILS**

I/we, as named in section 1, apply for a premises licence under section 17 of the Licensing Act 2003 for the premises described in section 2 below (the premises) and I/we are making this application to you as the relevant licensing authority in accordance with section 12 of the Licensing Act 2003.

**Premises Address**

Are you able to provide a postal address, OS map reference or description of the premises?

☒ Address    ☐ OS map reference    ☐ Description

**Postal Address Of Premises**

Building number or name	<input type="text" value="Craft Ale Bar"/>
Street	<input type="text" value="Castle St"/>
District	<input type="text"/>
City or town	<input type="text" value="Nantwich"/>
County or administrative area	<input type="text"/>
Postcode	<input type="text" value="CW55BA"/>
Country	<input type="text" value="United Kingdom"/>

**Further Details**

Telephone number	<input type="text"/>
Non-domestic rateable value of premises (£)	<input type="text" value="54,000"/>

**Section 3 of 21****APPLICATION DETAILS**

In what capacity are you applying for the premises licence?

- ☒ An individual or individuals
- ☐ A limited company / limited liability partnership
- ☐ A partnership (other than limited liability)
- ☐ An unincorporated association
- ☐ Other (for example a statutory corporation)
- ☐ A recognised club
- ☐ A charity
- ☐ The proprietor of an educational establishment
- ☐ A health service body
- ☐ A person who is registered under part 2 of the Care Standards Act 2000 (c14) in respect of an independent hospital in Wales
- ☐ A person who is registered under Chapter 2 of Part 1 of the Health and Social Care Act 2008 in respect of the carrying on of a regulated activity (within the meaning of that Part) in an independent hospital in England
- ☐ The chief officer of police of a police force in England and Wales

**Confirm The Following**

- ☒ I am carrying on or proposing to carry on a business which involves the use of the premises for licensable activities
- ☐ I am making the application pursuant to a statutory function
- ☐ I am making the application pursuant to a function discharged by virtue of Her Majesty's prerogative

**Section 4 of 21****INDIVIDUAL APPLICANT DETAILS****Applicant Name**

Is the name the same as (or similar to) the details given in section one?

- ☒ Yes ☐ No

If "Yes" is selected you can re-use the details from section one, or amend them as required. Select "No" to enter a completely new set of details.

First name

Pete

Family name

Terry

Is the applicant 18 years of age or older?

- ☒ Yes ☐ No

Continued from previous page...

**Current Residential Address**

Is the address the same as (or similar to) the address given in section one?

☒ Yes☐ No

If "Yes" is selected you can re-use the details from section one, or amend them as required. Select "No" to enter a completely new set of details.

Building number or name

Street

District

City or town

County or administrative area

Postcode

Country

United Kingdom

**Applicant Contact Details**

Are the contact details the same as (or similar to) those given in section one?

☒ Yes☐ No

If "Yes" is selected you can re-use the details from section one, or amend them as required. Select "No" to enter a completely new set of details.

E-mail

Telephone number

Other telephone number

\* Date of birth

dd

mm

yyyy

\* Nationality

Documents that demonstrate entitlement to work in the UK

Add another applicant

**Section 5 of 21****OPERATING SCHEDULE**

When do you want the premises licence to start?

 /  / 

dd

mm

yyyy

If you wish the licence to be valid only for a limited period, when do you want it to end

 /  / 

dd

mm

yyyy

Provide a general description of the premises

For example the type of premises, its general situation and layout and any other information which could be relevant to the licensing objectives. Where your application includes off-supplies of alcohol and you intend to provide a place for consumption of these off- supplies you must include a description of where the place will be and its proximity to the premises.

The New premises will be using approx 850 sq ft of The Studio Nightclub with a capacity off approx 60 Customers with

*Continued from previous page...*

loose seating for the majority with Off Sales so they can take there favourite Craft Ales home. It will be a self contained one room operation with its own entrance, toilet & have its own external drinking & smoking area completely independent from the existing business & covered by CCTV,  
The premise will have its own independent CCTV system that will record to hard drive for 31 days, all staff will be fully trained regarding to the 4 licensing objectives. The DPS will be a member of pubwatch. They will have a Town radio to help share information etc.

If 5,000 or more people are expected to attend the premises at any one time, state the number expected to attend

## Section 6 of 21

### PROVISION OF PLAYS

[See guidance on regulated entertainment](#)

Will you be providing plays?

☐ Yes ☒ No

## Section 7 of 21

### PROVISION OF FILMS

[See guidance on regulated entertainment](#)

Will you be providing films?

☐ Yes ☒ No

## Section 8 of 21

### PROVISION OF INDOOR SPORTING EVENTS

[See guidance on regulated entertainment](#)

Will you be providing indoor sporting events?

☐ Yes ☒ No

## Section 9 of 21

### PROVISION OF BOXING OR WRESTLING ENTERTAINMENTS

[See guidance on regulated entertainment](#)

Will you be providing boxing or wrestling entertainments?

☐ Yes ☒ No

## Section 10 of 21

### PROVISION OF LIVE MUSIC

[See guidance on regulated entertainment](#)

Will you be providing live music?

☒ Yes ☐ No

### Standard Days And Timings

MONDAY

Start

End

Start

End

Give timings in 24 hour clock.  
(e.g., 16:00) and only give details for the days of the week when you intend the premises to be used for the activity.

*Continued from previous page...*

TUESDAY

Start	<input type="text" value="10:00"/>	End	<input type="text" value="22:00"/>
Start	<input type="text"/>	End	<input type="text"/>

WEDNESDAY

Start	<input type="text" value="10:00"/>	End	<input type="text" value="22:00"/>
Start	<input type="text"/>	End	<input type="text"/>

THURSDAY

Start	<input type="text" value="10:00"/>	End	<input type="text" value="22:00"/>
Start	<input type="text"/>	End	<input type="text"/>

FRIDAY

Start	<input type="text" value="10:00"/>	End	<input type="text" value="22:00"/>
Start	<input type="text"/>	End	<input type="text"/>

SATURDAY

Start	<input type="text" value="10:00"/>	End	<input type="text" value="22:00"/>
Start	<input type="text"/>	End	<input type="text"/>

SUNDAY

Start	<input type="text" value="10:00"/>	End	<input type="text" value="22:00"/>
Start	<input type="text"/>	End	<input type="text"/>

Will the performance of live music take place indoors or outdoors or both?

☒ Indoors
 ☐ Outdoors
 ☐ Both

Where taking place in a building or other structure tick as appropriate. Indoors may include a tent.

State type of activity to be authorised, if not already stated, and give relevant further details, for example (but not exclusively) whether or not music will be amplified or unamplified.

Both Acoustic & Amplified

State any seasonal variations for the performance of live music

For example (but not exclusively) where the activity will occur on additional days during the summer months.

non

Non-standard timings. Where the premises will be used for the performance of live music at different times from those listed in the column on the left, list below



*Continued from previous page...*

For example (but not exclusively), where you wish the activity to go on longer on a particular day e.g. Christmas Eve.

Jazz Festival Weekend.

## Section 11 of 21

### PROVISION OF RECORDED MUSIC

[See guidance on regulated entertainment](#)

Will you be providing recorded music?

☒ Yes ☐ No

#### Standard Days And Timings

MONDAY

Start

End

Start

End

Give timings in 24 hour clock.  
(e.g., 16:00) and only give details for the days  
of the week when you intend the premises  
to be used for the activity.

TUESDAY

Start

End

Start

End

WEDNESDAY

Start

End

Start

End

THURSDAY

Start

End

Start

End

FRIDAY

Start

End

Start

End

SATURDAY

Start

End

Start

End

SUNDAY

Start

End

Start

End

Will the playing of recorded music take place indoors or outdoors or both?

☒ Indoors ☐ Outdoors ☐ Both

Where taking place in a building or other  
structure tick as appropriate. Indoors may  
include a tent.

*Continued from previous page...*

State type of activity to be authorised, if not already stated, and give relevant further details, for example (but not exclusively) whether or not music will be amplified or unamplified.

Both

State any seasonal variations for playing recorded music

For example (but not exclusively) where the activity will occur on additional days during the summer months.

Non-standard timings. Where the premises will be used for the playing of recorded music at different times from those listed in the column on the left, list below

For example (but not exclusively), where you wish the activity to go on longer on a particular day e.g. Christmas Eve.

## Section 12 of 21

### PROVISION OF PERFORMANCES OF DANCE

[See guidance on regulated entertainment](#)

Will you be providing performances of dance?

☐ Yes ☒ No

## Section 13 of 21

### PROVISION OF ANYTHING OF A SIMILAR DESCRIPTION TO LIVE MUSIC, RECORDED MUSIC OR PERFORMANCES OF DANCE

[See guidance on regulated entertainment](#)

Will you be providing anything similar to live music, recorded music or performances of dance?

☐ Yes ☒ No

## Section 14 of 21

### LATE NIGHT REFRESHMENT

Will you be providing late night refreshment?

☐ Yes ☒ No

## Section 15 of 21

### SUPPLY OF ALCOHOL

Will you be selling or supplying alcohol?

☒ Yes ☐ No

### Standard Days And Timings

Continued from previous page...

MONDAY

Start

End

Start

End

Give timings in 24 hour clock.  
(e.g., 16:00) and only give details for the days  
of the week when you intend the premises  
to be used for the activity.

TUESDAY

Start

End

Start

End

WEDNESDAY

Start

End

Start

End

THURSDAY

Start

End

Start

End

FRIDAY

Start

End

Start

End

SATURDAY

Start

End

Start

End

SUNDAY

Start

End

Start

End

Will the sale of alcohol be for consumption:

- ☐ On the premises ☐ Off the premises ☒ Both

If the sale of alcohol is for consumption on  
the premises select on, if the sale of alcohol  
is for consumption away from the premises  
select off. If the sale of alcohol is for  
consumption on the premises and away  
from the premises select both.

State any seasonal variations

For example (but not exclusively) where the activity will occur on additional days during the summer months.

n/a

Non-standard timings. Where the premises will be used for the supply of alcohol at different times from those listed in the column on the left, list below

*Continued from previous page...*

For example (but not exclusively), where you wish the activity to go on longer on a particular day e.g. Christmas Eve.

n/a

State the name and details of the individual whom you wish to specify on the licence as premises supervisor

### Name

First name

Family name

Date of birth  /  /

### Enter the contact's address

Building number or name

Street

District

City or town

County or administrative area

Postcode

Country

Personal Licence number (if known)

Issuing licensing authority (if known)

### PROPOSED DESIGNATED PREMISES SUPERVISOR CONSENT

How will the consent form of the proposed designated premises supervisor be supplied to the authority?

- ☒ Electronically, by the proposed designated premises supervisor
- ☐ As an attachment to this application

Reference number for consent form (if known)

If the consent form is already submitted, ask the proposed designated premises supervisor for its 'system reference' or 'your reference'.

### Section 16 of 21

### ADULT ENTERTAINMENT

*Continued from previous page...*

Highlight any adult entertainment or services, activities, or other entertainment or matters ancillary to the use of the premises that may give rise to concern in respect of children

Give information about anything intended to occur at the premises or ancillary to the use of the premises which may give rise to concern in respect of children, regardless of whether you intend children to have access to the premises, for example (but not exclusively) nudity or semi-nudity, films for restricted age groups etc gambling machines etc.

N/A

## Section 17 of 21

### HOURS PREMISES ARE OPEN TO THE PUBLIC

#### Standard Days And Timings

##### MONDAY

Start

End

Start

End

Give timings in 24 hour clock.  
(e.g., 16:00) and only give details for the days  
of the week when you intend the premises  
to be used for the activity.

##### TUESDAY

Start

End

Start

End

##### WEDNESDAY

Start

End

Start

End

##### THURSDAY

Start

End

Start

End

##### FRIDAY

Start

End

Start

End

##### SATURDAY

Start

End

Start

End

##### SUNDAY

Start

End

Start

End

State any seasonal variations

For example (but not exclusively) where the activity will occur on additional days during the summer months.

*Continued from previous page...*

Non standard timings. Where you intend to use the premises to be open to the members and guests at different times from those listed in the column on the left, list below

For example (but not exclusively), where you wish the activity to go on longer on a particular day e.g. Christmas Eve.

Jazz Festival.

## Section 18 of 21

### LICENSING OBJECTIVES

Describe the steps you intend to take to promote the four licensing objectives:

a) General – all four licensing objectives (b,c,d,e)

List here steps you will take to promote all four licensing objectives together.

TO PROMOTE ALL FOUR LICENSING OBJECTIVES WE WILL KEEP:

Strong management controls and effective training of all staff so that they are aware of the premises licence and the requirements to meet the four licensing objectives with particular attention to:

a/ no selling of alcohol to underage people

b/ no drunk and disorderly behavior on the premises area

c/ vigilance in preventing the use and sale of illegal drugs at the retail area

d/ no violent and anti-social behaviour

e/ no harm to children

- Operating Schedule providing the hours of operation and licensable activities during those hours.

- Designated premises supervisor confirmed it is obligated to be in day-to-day control of the premises, to provide good training for staff on the Licensing Act (Training Record), to make or authorize each sale

- Clear "Challenge 25" information to prevent the supply of alcohol to under-age drinkers.

- CCTV system installed with recording option available

As a licensed premises we know that it is necessary to carry out our functions or operate their businesses with a purpose of promoting these objectives. We promise to support these objectives through their operating schedules and other measures (including staff training and qualifications, policies, and strategic partnerships with other agencies).

b) The prevention of crime and disorder

CCTV System installed to monitor entrances, exits, and other parts of the premises in order to address the prevention of crime objective.

Not selling of alcohol to drunk or intoxicated customers.

Prevention and vigilance in illegal drug use on the premises.

Staff will be well trained in asking customers to use premises in an orderly and respectful manner.

c) Public safety

Internal and external lighting fixed to promote the public safety objective.

Well trained staff adherence to environmental health requirements.

Training and implementation of underage ID checks.

A log book or recording system shall be kept upon the premises in which shall be entered particulars of inspections made; those required to be made by statute, and information compiled.

*Continued from previous page...*

All parts of the premises and all fittings and apparatus therein, door fastenings and notices, lighting, heating, electrical, air condition, sanitary accommodation and other installations, will be maintained at all times in good order and in a safe condition.

d) The prevention of public nuisance

Prominent, clear and legible notices will be displayed at the exit requesting the public to respect the needs of nearby residents and to leave the premises and the area quietly.  
Deliveries of goods necessary for the operation of the business will be carried out at such a time or in such a manner as to prevent nuisance and disturbance to nearby residents.  
The Licensee will ensure that staff who arrive early morning or depart late at night when the business has ceased trading conduct themselves in such a manner to avoid causing disturbance to nearby residents.  
Customers will not be admitted to premises above opening hours.

e) The protection of children from harm

"Challenge 25" sign for anyone who is over 18 but looks under 25 to carry acceptable ID (a card bearing the PASS hologram, a photographic driving license or a passport) if they wish to buy alcohol.  
Well trained staff, to age check everyone that looks Under 25.  
All the details provided in Training Record Book available at the retail unit.  
Log Book will be kept upon the premises all the time.

**Section 19 of 21**

**NOTES ON DEMONSTRATING ENTITLEMENT TO WORK IN THE UK**

*Continued from previous page...*

**Entitlement to work/immigration status for individual applicants and applications from partnerships which are not limited liability partnerships:**

A licence may not be held by an individual or an individual in a partnership who is resident in the UK who:

- does not have the right to live and work in the UK; or
- is subject to a condition preventing him or her from doing work relating to the carrying on of a licensable activity.

Any premises licence issued in respect of an application made on or after 6 April 2017 will become invalid if the holder ceases to be entitled to work in the UK.

Applicants must demonstrate that they have an entitlement to work in the UK and are not subject to a condition preventing them from doing work relating to the carrying on of a licensable activity. They do this by providing with this application copies or scanned copies of the following documents (which do not need to be certified).

**Documents which demonstrate entitlement to work in the UK**

- An expired or current passport showing the holder, or a person named in the passport as the child of the holder, is a British citizen or a citizen of the UK and Colonies having the right of abode in the UK [please see note below about which sections of the passport to copy].
- An expired or current passport or national identity card showing the holder, or a person named in the passport as the child of the holder, is a national of a European Economic Area country or Switzerland.
- A Registration Certificate or document certifying permanent residence issued by the Home Office to a national of a European Economic Area country or Switzerland.
- A Permanent Residence Card issued by the Home Office to the family member of a national of a European Economic Area country or Switzerland.
- A **current** Biometric Immigration Document (Biometric Residence Permit) issued by the Home Office to the holder indicating that the person named is allowed to stay indefinitely in the UK, or has no time limit on their stay in the UK.
- A **current** passport endorsed to show that the holder is exempt from immigration control, is allowed to stay indefinitely in the UK, has the right of abode in the UK, or has no time limit on their stay in the UK.
- A **current** Immigration Status Document issued by the Home Office to the holder with an endorsement indicating that the named person is allowed to stay indefinitely in the UK or has no time limit on their stay in the UK, **when produced in combination with** an official document giving the person's permanent National Insurance number and their name issued by a Government agency or a previous employer.
- A **full** birth or adoption certificate issued in the UK which includes the name(s) of at least one of the holder's parents or adoptive parents, **when produced in combination with** an official document giving the person's permanent National Insurance number and their name issued by a Government agency or a previous employer.
- A birth or adoption certificate issued in the Channel Islands, the Isle of Man or Ireland **when produced in combination with** an official document giving the person's permanent National Insurance number and their name issued by a Government agency or a previous employer.
- A certificate of registration or naturalisation as a British citizen, **when produced in combination with** an official document giving the person's permanent National Insurance number and their name issued by a Government agency or a previous employer.
- A **current** passport endorsed to show that the holder is allowed to stay in the UK and is currently allowed to work and is not subject to a condition preventing the holder from doing work relating to the carrying on of a licensable activity.



*Continued from previous page...*

- A **current** Biometric Immigration Document (Biometric Residence Permit) issued by the Home Office to the holder which indicates that the named person can currently stay in the UK and is allowed to work relation to the carrying on of a licensable activity.
- A **current** Residence Card issued by the Home Office to a person who is not a national of a European Economic Area state or Switzerland but who is a family member of such a national or who has derivative rights or residence.
- A **current** Immigration Status Document containing a photograph issued by the Home Office to the holder with an endorsement indicating that the named person may stay in the UK, and is allowed to work and is not subject to a condition preventing the holder from doing work relating to the carrying on of a licensable activity **when produced in combination with** an official document giving the person's permanent National Insurance number and their name issued by a Government agency or a previous employer.
- A Certificate of Application, **less than 6 months old**, issued by the Home Office under regulation 17(3) or 18A (2) of the Immigration (European Economic Area) Regulations 2006, to a person who is not a national of a European Economic Area state or Switzerland but who is a family member of such a national or who has derivative rights of residence.
- Reasonable evidence that the person has an outstanding application to vary their permission to be in the UK with the Home Office such as the Home Office acknowledgement letter or proof of postage evidence, or reasonable evidence that the person has an appeal or administrative review pending on an immigration decision, such as an appeal or administrative review reference number.
- Reasonable evidence that a person who is not a national of a European Economic Area state or Switzerland but who is a family member of such a national or who has derivative rights of residence in exercising treaty rights in the UK including:-
  - evidence of the applicant's own identity – such as a passport,
  - evidence of their relationship with the European Economic Area family member – e.g. a marriage certificate, civil partnership certificate or birth certificate, and
  - evidence that the European Economic Area national has a right of permanent residence in the UK or is one of the following if they have been in the UK for more than 3 months:
    - (i) working e.g. employment contract, wage slips, letter from the employer,
    - (ii) self-employed e.g. contracts, invoices, or audited accounts with a bank,
    - (iii) studying e.g. letter from the school, college or university and evidence of sufficient funds; or
    - (iv) self-sufficient e.g. bank statements.

Family members of European Economic Area nationals who are studying or financially independent must also provide evidence that the European Economic Area national and any family members hold comprehensive sickness insurance in the UK. This can include a private medical insurance policy, an EHIC card or an S1, S2 or S3 form.

**Original documents must not be sent to licensing authorities.** If the document copied is a passport, a copy of the following pages should be provided:-

- (i) any page containing the holder's personal details including nationality;
- (ii) any page containing the holder's photograph;
- (iii) any page containing the holder's signature;
- (iv) any page containing the date of expiry; and
- (v) any page containing information indicating the holder has permission to enter or remain in the UK and is permitted to work.

If the document is not a passport, a copy of the whole document should be provided.

Your right to work will be checked as part of your licensing application and this could involve us checking your immigration status with the Home Office. We may otherwise share information with the Home Office. Your licence application will not be determined until you have complied with this guidance.

## Section 20 of 21

### NOTES ON REGULATED ENTERTAINMENT

*Continued from previous page...*

In terms of specific **regulated entertainments** please note that:

- Plays: no licence is required for performances between 08:00 and 23.00 on any day, provided that the audience does not exceed 500.
- Films: no licence is required for 'not-for-profit' film exhibition held in community premises between 08.00 and 23.00 on any day provided that the audience does not exceed 500 and the organiser (a) gets consent to the screening from a person who is responsible for the premises; and (b) ensures that each such screening abides by age classification ratings.
- Indoor sporting events: no licence is required for performances between 08.00 and 23.00 on any day, provided that the audience does not exceed 1000.
- Boxing or Wrestling Entertainment: no licence is required for a contest, exhibition or display of Greco-Roman wrestling, or freestyle wrestling between 08.00 and 23.00 on any day, provided that the audience does not exceed 1000. Combined fighting sports – defined as a contest, exhibition or display which combines boxing or wrestling with one or more martial arts – are licensable as a boxing or wrestling entertainment rather than an indoor sporting event.
- Live music: no licence permission is required for:
  - o a performance of unamplified live music between 08.00 and 23.00 on any day, on any premises.
  - o a performance of amplified live music between 08.00 and 23.00 on any day on premises authorised to sell alcohol for consumption on those premises, provided that the audience does not exceed 500.
  - o a performance of amplified live music between 08.00 and 23.00 on any day, in a workplace that is not licensed to sell alcohol on those premises, provided that the audience does not exceed 500.
  - o a performance of amplified live music between 08.00 and 23.00 on any day, in a church hall, village hall, community hall, or other similar community premises, that is not licensed by a premises licence to sell alcohol, provided that (a) the audience does not exceed 500, and (b) the organiser gets consent for the performance from a person who is responsible for the premises.
  - o a performance of amplified live music between 08.00 and 23.00 on any day, at the non-residential premises of (i) a local authority, or (ii) a school, or (iii) a hospital, provided that (a) the audience does not exceed 500, and (b) the organiser gets consent for the performance on the relevant premises from: (i) the local authority concerned, or (ii) the school or (iii) the health care provider for the hospital.
- Recorded Music: no licence permission is required for:
  - o any playing of recorded music between 08.00 and 23.00 on any day on premises authorised to sell alcohol for consumption on those premises, provided that the audience does not exceed 500.
  - o any playing of recorded music between 08.00 and 23.00 on any day, in a church hall, village hall, community hall, or other similar community premises, that is not licensed by a premises licence to sell alcohol, provided that (a) the audience does not exceed 500, and (b) the organiser gets consent for the performance from a person who is responsible for the premises.
  - o any playing of recorded music between 08.00 and 23.00 on any day, at the non-residential premises of (i) a local authority, or (ii) a school, or (iii) a hospital, provided that (a) the audience does not exceed 500, and (b) the organiser gets consent for the performance on the relevant premises from: (i) the local authority concerned, or (ii) the school proprietor or (iii) the health care provider for the hospital.

**Continued from previous page...**

- Dance: no licence is required for performances between 08.00 and 23.00 on any day, provided that the audience does not exceed 500. However, a performance which amounts to adult entertainment remains licensable.
- Cross activity exemptions: no licence is required between 08.00 and 23.00 on any day, with no limit on audience size for:
  - o any entertainment taking place on the premises of the local authority where the entertainment is provided by or on behalf of the local authority;
  - o any entertainment taking place on the hospital premises of the health care provider where the entertainment is provided by or on behalf of the health care provider;
  - o any entertainment taking place on the premises of the school where the entertainment is provided by or on behalf of the school proprietor; and
  - o any entertainment (excluding films and a boxing or wrestling entertainment) taking place at a travelling circus, provided that (a) it takes place within a moveable structure that accommodates the audience, and (b) that the travelling circus has not been located on the same site for more than 28 consecutive days.

**Section 21 of 21****PAYMENT DETAILS**

This fee must be paid to the authority. If you complete the application online, you must pay it by debit or credit card.

Premises Licence Fees are determined by the non&nbsp;domestic rateable&nbsp;value of the premises.

To find out a premises non domestic rateable value go to the Valuation Office Agency site at [http://www.voa.gov.uk/business\\_rates/index.htm](http://www.voa.gov.uk/business_rates/index.htm)

Band A - No RV to £4300 £100.00

Band B - £4301 to £33000 £190.00

Band C - £33001 to £8700 £315.00

Band D - £87001 to £12500 £450.00\*

Band E - £125001 and over £635.00\*

\*If the premises rateable value is in Bands D or E and the premises is primarily used for the consumption of alcohol on the premises then you are required to pay a higher fee

Band D - £87001 to £12500 £900.00

Band E - £125001 and over £1,905.00

There is an exemption from the payment of fees in relation to the provision of regulated entertainment at church halls, chapel halls or premises of a similar nature, village halls, parish or community halls, or other premises of a similar nature. The costs associated with these licences will be met by central Government. If, however, the licence also authorises the use of the premises for the supply of alcohol or the provision of late night refreshment, a fee will be required.

Schools and sixth form colleges are exempt from the fees associated with the authorisation of regulated entertainment where the entertainment is provided by and at the school or college and for the purposes of the school or college.

If you operate a large event you are subject to ADDITIONAL fees based upon the number in attendance at any one time

Capacity 5000-9999 £1,000.00

Capacity 10000 -14999 £2,000.00

Capacity 15000-19999 £4,000.00

Capacity 20000-29999 £8,000.00

Capacity 30000-39000 £16,000.00

Capacity 40000-49999 £24,000.00

Capacity 50000-59999 £32,000.00

Capacity 60000-69999 £40,000.00

Capacity 70000-79999 £48,000.00

Capacity 80000-89999 £56,000.00

Capacity 90000 and over £64,000.00

\* Fee amount (£)

315.00

**DECLARATION**

*Continued from previous page...*

\* I/we understand it is an offence, liable on conviction to a fine up to level 5 on the standard scale, under section 158 of the licensing act 2003, to make a false statement in or in connection with this application.

Applicable to individual applicants only, including those in a partnership which is not a limited liability partnership] I understand I am not entitled to be issued with a licence if I do not have the entitlement to live and work in the UK (or if I am subject to a condition preventing me from doing work relating to the carrying on of a licensable activity) and that my licence will become invalid if I cease to be entitled to live and work in the UK (please read guidance note 15).

The DPS named in this application form is entitled to work in the UK (and is not subject to conditions preventing him or her from doing work relating to a licensable activity) and I have seen a copy of his or her proof of entitlement to work, if appropriate (please see note 15).

☒ Ticking this box indicates you have read and understood the above declaration

This section should be completed by the applicant, unless you answered "Yes" to the question "Are you an agent acting on behalf of the applicant?"

\* Full name

\* Capacity

\* Date

[Add another signatory](#)

Once you're finished you need to do the following:

1. Save this form to your computer by clicking file/save as...
2. Go back to <https://www.gov.uk/apply-for-a-licence/premises-licence/cheshire-east/apply-1> to upload this file and continue with your application.

Don't forget to make sure you have all your supporting documentation to hand.

**IT IS AN OFFENCE LIABLE TO SUMMARY CONVICTION TO A FINE OF ANY AMOUNT UNDER SECTION 158 OF THE LICENSING ACT 2003, TO MAKE A FALSE STATEMENT IN OR IN CONNECTION WITH THIS APPLICATION**

**IT IS AN OFFENCE UNDER SECTION 24B OF THE IMMIGRATION ACT 1971 FOR A PERSON TO WORK WHEN THEY KNOW, OR HAVE REASONABLE CAUSE TO BELIEVE, THAT THEY ARE DISQUALIFIED FROM DOING SO BY REASON OF THEIR IMMIGRATION STATUS. THOSE WHO EMPLOY AN ADULT WITHOUT LEAVE OR WHO IS SUBJECT TO CONDITIONS AS TO EMPLOYMENT WILL BE LIABLE TO A CIVIL PENALTY UNDER SECTION 15 OF THE IMMIGRATION, ASYLUM AND NATIONALITY ACT 2006 AND PURSUANT TO SECTION 21 OF THE SAME ACT, WILL BE COMMITTING AN OFFENCE WHERE THEY DO SO IN THE KNOWLEDGE, OR WITH REASONABLE CAUSE TO BELIEVE, THAT THE EMPLOYEE IS DISQUALIFIED**

OFFICE USE ONLY	
Applicant reference number	<input type="text"/>
Fee paid	<input type="text"/>
Payment provider reference	<input type="text"/>
ELMS Payment Reference	<input type="text"/>
Payment status	<input type="text"/>
Payment authorisation code	<input type="text"/>
Payment authorisation date	<input type="text"/>
Date and time submitted	<input type="text"/>
Approval deadline	<input type="text"/>
Error message	<input type="text"/>
Is Digitally signed	<input type="checkbox"/>

< Previous   [1](#)   [2](#)   [3](#)   [4](#)   [5](#)   [6](#)   [7](#)   [8](#)   [9](#)   [10](#)   [11](#)   [12](#)   [13](#)   [14](#)   [15](#)   [16](#)   [17](#)   [18](#)   [19](#)   [20](#)   [21](#)   Next >

**This page is intentionally left blank**

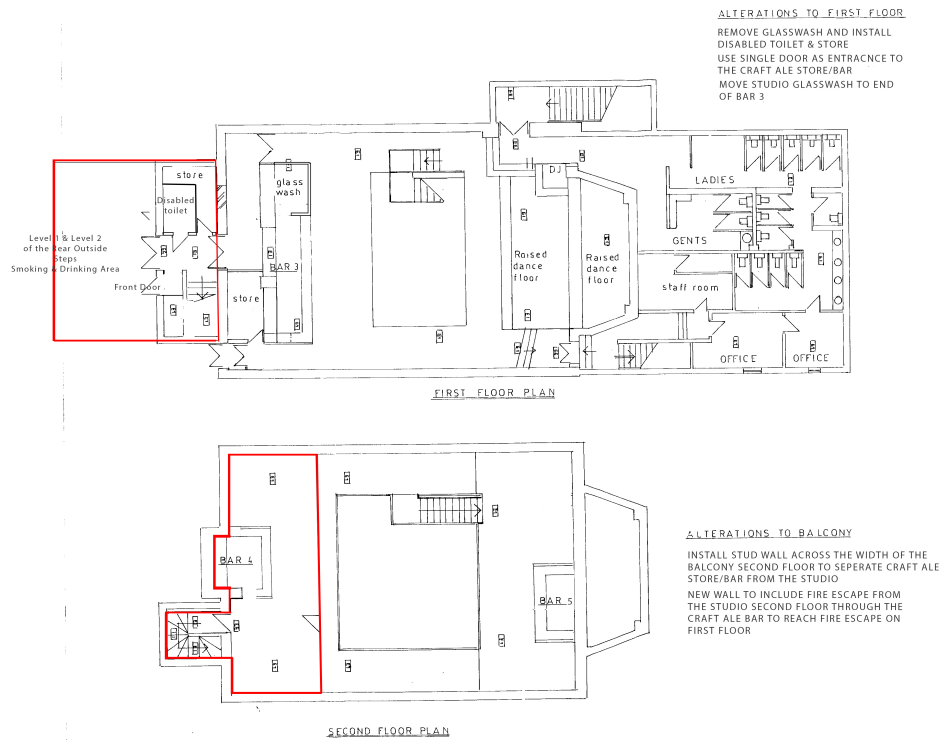

**This page is intentionally left blank**



-----Original Message-----

From: [REDACTED]

Sent: 09-Jul-2017 15:20

To: LICENSING (Cheshire East)

Cc: [REDACTED]

[REDACTED]

Subject: Making a representation - Craft Ale Bar, Castle Street, Nantwich, CW5 5BA

Dear Sirs

Whilst this is correspondence relating to making formal representation against yet another premises licence, I have also copied this email to the following, in the hope that some of the issues can also be address as they all relate:

- Cllr Groves
- Nantwich Town Council - [REDACTED]
- Laura Smith MP
- Nantwich Police Station - [REDACTED]

I hereby write to make formal Representation against the Application for a Premises Licence for the above named premises which is applying for the following licensable activities:

- provision of live music, recorded music and supply of alcohol Monday to Sunday 10:00-22:00
- opening hours Monday-Sunday 10:00-22:30

My reasons for making a Representation is as follows:

Currently the premises known as 'The Studio' already has a licence to operate and I live at the back of this property, I have attached photographs (Ref: images 1,2 and 3) which are taken from my living room windows, which show how close The Studio is to my home.

Also is a photograph taken from the back steps towards my home (Ref: image 3), this is where the new application - Craft Ale Bar, wishes to serve/ access and/or operate from, for reference in this correspondence I shall refer to this area as the 'red steps'.

There are weekly occasions when youths hang around on the red steps and generally cause a nuisance and disturbance, the area itself is very poorly kept and quite frankly is a disgrace to the Town appearance, ideally the Town Council and CEC should invest some of it's sanitation and highway cleaning to this area, I attach 2 photos (Ref: image 4 and 5) which shows this littering issue.

I cannot understand why anyone would want to use Castle Street for any reason as this area is a complete disgrace, and looks like a dirty, unsafe down-town back alley which is why it attracts such undesirables - in any case the Police should be more proactively patrolling this area, despite what is written on their website 'you said, we did'.

In terms of the Craft Ale Bar licence application, I and numerous other residents have been subjected to abuse from the youths who hang around on the red steps, only Thursday of last week, there were a gang who kicked a football over the wall and then climbed onto the flat roof, which you can see on the photographs and then promptly hurled profanity and abuse towards my neighbour who was in her garden, this is completely unacceptable. There was also an instance where a golf ball was thrown over, can you imagine what would have happened if this had hit anyone on the head - heaven help them if it had hit one of my children!!!

I have also had youths climb onto the flat roof and have had eggs thrown at my living room windows, this was reported to the Police, and to date I have had no contact with anyone, and still the youths hang around there!

I am aware that Nigel (the licensee of The Studio) knows about a drug issue on the red steps, even by his own admission he and staff have to clean up the steps most mornings as they find little empty packets of what looks like white powder that have been left and litter the area, again, how long will it be before someone accidentally picks one of these up and something serious happens - again Nantwich Town Council and CEC have a responsibility here, and nothing appears to be being done - Nantwich clearly has a drug issue and a youth drinking issue, therefore my objection will hopefully reach both the local police (although I believe they already know about these, but as yet we as residents do not see any action), I also hope that my objection will be seen by Councillors for Nantwich Town Council as I think that we all have a responsibility to keep Nantwich safe and clean and we should all take more pride in our Town, instead of just granting more and more alcohol licences.

My representation objection to Craft Ale is furthermore compounded with my query as to where patrons of Craft Ale (and indeed The Studio in its current form) will go to smoke - again I refer to the attached photographs (Ref: image 4 and 5), I fear that cigarette butts will be tossed over the wall, or even just dumped on the red steps.

My additional concern is that whilst the application for licence says that the doors and windows will remain closed during Craft Ale operating times, there is absolutely no way that this will be upheld, and we as the residents who will only be a brick wall behind this in our gardens, will be subjected to patrons standing outside, drinking, smoking and generally hanging around, despite the licencing officer saying that most people will only be going to Craft Ale to buy and then moving on, I refute this by saying that people will buy a drink and some will want to stay to drink it. Therefore chairs and tables will suddenly appear on the red steps and again we the local residents will be disturbed by the noise, music, drinking, swearing etc etc ...

We are already being closed in, the Studio is behind us, AND we have the Wickstead at the front of us. Between these 2 establishments, there are already unreasonable disturbances on Tuesday nights (until 3am) from the Studio (and yes there is sound leakage from the DJ, and yes there is noise, shouting etc as people are coming in and out and after closing time - some of us are up for work early and have to put up with this noise EVERY Tuesday/ Wednesday morning, then on Friday and Saturday nights for both the Wickstead and the Studio, and if this licence goes ahead this will increase to 7 nights a week until 22:00/ 22:30 ... how many more drinking places need to be opened, until Nantwich is just left as a drinking town ... Eventually the Town Council,

and Cheshire East Council will open their eyes and find that they have created a ghost town only used by drinkers and drug users, for which I hope you will all be proud. Instead of appeasing these groups, why not make a stand now and start to take responsibility for the community, and society as a whole.

In short, my objections against the Craft Ale Bar licence are related to:

- the prevention of crime and disorder
  - the prevention of public nuisance.
- and,
- the protection of children from harm (not only the youths who may be involved in the drinking and drug taking, but I also have 2 children (aged 8 and 14) and quite frankly, by living where I do I now greatly fear for their safety being surrounded by such premises.

Finally in summary, having copied this email to Nantwich Town Council, I wish to add that the website states:

'A beautiful town, adorned with boutiques, antiques, cafes, pubs and restaurants and steeped in history' If these alcohol licences continue to be granted, and the existing licences are not managed, as some currently are not, then this statement becomes null and void - the Council must step in and see what is happening around them. You only have to look around outside Swine Market/ Oat Market on a Wednesday morning to see how our 'beautiful town' has been left after a night of drink fuelled revellers. It is a disgrace.

I wish to have a receipt correspondence that my Representation has been received and I also wish for a regular update in these matters. At this stage, I do not want my contact details to be passed onto ANYONE else unless I am contacted prior.

Yours sincerely

[REDACTED]  
[REDACTED]  
[REDACTED]

**This page is intentionally left blank**







**This page is intentionally left blank**



# LICENSING ACT 2003

## Environmental Health Consultation

### Response



EP Ref: ELL/053214

Date Received: 12 June 2017

Name of Applicant: Craft Ale Bar

Address to which application relates: Castle Street, Nantwich, Cheshire, CW5 5BA

Conversion: ☐ Variation: ☐ New: ☒

<input type="checkbox"/>	Approve
<input checked="" type="checkbox"/>	Approve with Conditions
<input type="checkbox"/>	Object to Section(s)

### Proposed Conditions

The following conditions should be applied:

### Prevention of Public Nuisance

In order to protect the interest of local residents and ensure that the licensing objective of public nuisance prevention is upheld: all necessary steps shall be taken to ensure that any noise from the premises shall not be at a level which could cause a noise nuisance at the boundary of the nearest residential premises, therefore:

- No music, except for background music, to be played in the outside drinking area.
- Noise emanating from the premises shall not cause a nuisance at the boundary of any residential premises.
- All external windows and doors shall be closed whilst entertainment is taking place, except for normal access and egress.
- There shall be notices located at the exit(s) requesting that customers leaving the premises do so quietly and with consideration to neighbours.
- There shall be no disposal of bottles outside the premises between the hours of 20.00 and 08.00.

Signed: Sarah Allwood

Dated: 19<sup>th</sup> June 2017

Direct Dial: [REDACTED]

Email: [REDACTED]

**This page is intentionally left blank**

## **Relevant Sections of Cheshire East Licensing Policy**

### **6. Anti-Social Behaviour**

6.1 The Licensing Authority recognises that in addition to the requirements for it to promote the Licensing Objectives, the Council has a duty under section 17 of the Crime and Disorder Act 1998 to do all it reasonably can to prevent crime and disorder within its area.

6.2 The objective of the licensing process is to allow the retail sale of alcohol and the provision of other Licensable Activities in a manner that ensures the public's safety and which is neither to the detriment of residents, nor gives rise to loss of amenity. It is the Licensing Authority's aim to facilitate well run and managed premises with premises licence holders displaying sensitivity to the impact of their premises on local residents.

6.3 In accordance with the Guidance, the Licensing Authority does not regard this policy as a mechanism for the general control of anti-social behaviour by individuals once they have left the immediate vicinity of the licensed premises.

6.4 Recurring problems of alcohol-related anti-social behaviour, crime and disorder or serious public nuisance can occur in an area, which are not directly attributable to specific premises. In such cases, particularly if supported by the Police, the Licensing Authority may consider whether an Early Morning Alcohol Restriction Order (EMROs) might address the problems. These Orders are considered later in this Policy.

### **9. Prevention of Public Nuisance**

9.1 If Relevant Representations are received the Licensing Authority, when making an objective judgment about what constitutes a nuisance in respect of an application or review of a premises licence or certificate, will take a broad common law meaning when considering matters such as:

- Noise from premises
- Waste
- Litter
- Car parking
- Light pollution
- Noxious odours

9.2 In considering the potential impact of licensed premises on the surrounding locality the Licensing Authority, when in receipt of any Relevant Representations will take into account the type of entertainment activity proposed hours of operation, the capacity of the premises, the character of the areas and the proximity to local residents. Consideration will be given to the potential steps which could be taken to reduce the risk of nuisance occurring. This will particularly apply in areas where there is residential accommodation in the proximity of the premises.

Noise and Vibration

9.3 In order to enforce the provisions of the Environmental Protection Act 1990 (which relate to noise nuisance) the Police, Environmental Health Officers and Licensing Officers will liaise to ensure that adequate control measures are properly used to protect the local environment. Any action taken will be conducted in accordance with relevant enforcement policies

9.4 Consideration will be given to whether the operating schedule contains adequate measures to prevent noise and vibration, generated from within the premises, outside it, or from an open site, that may cause disturbance. Stricter conditions will be considered on premises in areas that have denser residential accommodation or have residential accommodation close to them. Noise includes music and human voices. Measures in the Operating Schedule may include installation of soundproofing, air conditioning, acoustic lobbies, sound limitation devices or locking doors at specified hours. If the proposed operating schedule fails to address noise nuisance issues, the Environmental Health Department may request that an independent acoustic report is conducted. Environmental Health may use any recommendations from such a report to propose amendments to the Operating Schedule or suggest conditions for the consideration of any (Sub) Committee.

9.5 Applicants will be expected to have included measures in their Operating Schedules that make adequate provision to:

- Restrict the generation of any noise within the premises and from activities associated with the premises in the vicinity, or from an open air site
- Limit the escape of any noise from the premises or open air site
- Restrict any noise emissions to below levels that could affect people in the vicinity going about their business, at work and when at home both while relaxing and while sleeping
- Minimise and control any noise from customers arriving and departing from the premises

9.6 The Licensing Authority will not impose conditions on licensed premises that cannot be directly controlled, or on matters not related to the vicinity of the premises.

9.7 If it is considered that any noise emanating from within the curtilage of a licensed premises is causing a public nuisance, under the provisions of the Anti-Social Behaviour Act 2003, an Authorised Officer can require its immediate closure for a period of up to 24 hours. It should be noted that the 'test' is a lesser one than that required to determine a Statutory Noise Nuisance and the statutory defence of 'best practicable means' is not available.



**This page is intentionally left blank**